

ADDENDUM #1

TO

CONTRACT DOCUMENTS

Hudson Dog Park

HUDSON, MASSACHUSETTS

June 02, 2025

NOTICE TO BIDDERS

The attention of all bidders submitting proposals for “**Hudson Dog Park**” is called to the following Addenda to the printed specifications and plans. The items set forth herein, whether of omission, addition or substitution are to be included in, and form part of the specifications and plans of the above named project for bids to be received as advertised.

The following clarifications, modifications, deletions, and additions are hereby incorporated into and become part of the Contract Documents.

Receipt of this Addendum shall be noted on the Form for Bid

Bids must be submitted before **12:00 P.M., Boston time, Monday, June 9, 2025**. There is no change in this bid submission time.

QUESTIONS WITH RESPONSES:

1.0 What is to be done with the Water Test Point?

- Modification to Contract Drawing sheet SP1 & L2: Contractor to remove existing pedestal to well test point and install a new flush mounted test cover (provided by Contractor). Location to be verified in the field.

2.0 Can you confirm the water and electric conduit can be in same trench?

- Modification to Contract Drawing sheet SP1, L2, & LD1: Water and electrical conduit cannot be installed in the same trench as shown in the drawings and shall be in separate trenches. Trenches shall be separated by a minimum horizontal distance of 36". Revised plans are attached to addendum #1.

3.0 Can you confirm the plumber vs contractor responsibilities?

- Plumber (by owner) will be responsible for installing all water supply lines and making final connections to drinking fountains. Water supply lines will be stubbed up above final grade during initial installation at location of drinking fountains, in advance of concrete work. Once the drinking fountain is mounted (by Contractor), the plumber (by owner) will make final connections.
- Contractor is responsible for trenching, preparing the area for water supply line installation, and providing and installing proper bedding material as required to fill/close

the trench per code. Contractor is responsible for mounting the drinking fountain (supplied by owner) and drain/drywell installation.

4.0 Can you confirm electrician vs contractor responsibilities and how the conduit is terminated at or under final grade (plastic box?)?

- Electrician (by owner) will be responsible for installing all conduit, including the handhole that will be installed flush to final grade at the end of the conduit run within the dog park play area. Contractor to trench/prepare the area for conduit installation, provide and install proper bedding for electrical conduit as well as required material to fill/close the trench per code.

5.0 Work to be performed Mon-Fri not on weekends, unless special permission granted by TOH.

6.0 No SWPP or NPDEPS is required for this project.

7.0 Who is responsible for providing final as-built drawings?

- Contractor to provide marked-up plans that include all changes to the construction documents and submit mark-ups to the Landscape Architect.

8.0 Can removed trees be chipped and used as mulch on site?

- No, please see specifications for new mulch requirements. Selective logs may be kept on site to use as placed logs per the construction documents.

9.0 What trees are being removed within the dog park?

- Several trees to be removed are noted on the construction drawings. In addition, trees under 8" DBH within the footprints of proposed walkways and hardscape and are to be removed. Contractor is responsible for providing stakes of proposed features and coordinating a site visit with the Landscape Architect to review trees to be removed, prior to any removals.

10.0 What is the clearing scope along Main Street?

- Clarification to Contract Drawing sheet SP1: There are (3) trees over 12" DBH and 1 overhanging limb at the park driveway entrance to be removed. All understory brush to be cut flush with grade in areas designated on the construction drawings. The Contractor is responsible for providing a police detail if tree work will impact the roadway.

11.0 Are stamped drawings required for the vehicular gate?

- Stamped drawings are not required for the vehicular gate, but Contractor is responsible for providing a submittal with dimensions and materials for approval.

12.0 How many parking sign posts are included in the scope?

- Clarification to Contract Drawing sheet L2: Per the construction documents, the Contractor is responsible for providing (2) posts at non-accessible parking without signs (owner to supply and install signs at a later date), and (1) sign post with accessible parking signage (by Contractor) at the accessible parking stall.

13.0 Who is responsible for assembling the furniture?

- The Contractor is responsible for the assembly and installation of site furnishings.

14.0 Clarifications to Instruction to Bidders, Specification Section 00 21 13, page 5:

- All inquiries must be received by General Bidders no later than 12:00 P.M. EST on June 2, 2025. Responses to all inquiries will be posted in an addendum on the Town's website no later than June 4, 2025, by 12:00P.M.

15.0 Modifications to Specification Section 02 41 00: Site Preparation and Demolition:

- All mentions of "Town of Westborough" shall be replaced with "Town of Hudson".

16.0 A list of Contractors that attended the pre-bid walk:

Rick Lovely
Busy Bee Nursery
508-829-5380
busybeenursery@busybee.com

Doug Brown
P.W. Brown Inc
508-898-3805
pwbrowninc@aol.com

Dan Desmond
Desmond Landscape
978-837-8101
Ddesm62@aol.com

Tobias Silva
PEI Contractors
508-454-2637
tsilva@pei-contractors.com

LEGEND

- L.O.W. LIMIT OF WORK LINE
- +++++ EROSION CONTROL -STRAW WATTLE, TYP. (2 LD1)
- TREE PROTECTION FENCE (1 LD1)
- ✕ TREE TO BE REMOVED
- CONSTRUCTION FENCE AND CONSTRUCTION SIGN
- CLEAR AND GRUB UNDERSTORY VEGETATION, MATURE TREES TO REMAIN
- REMOVE AND STOCKPILE GRAVEL
- EXISTING GRAVEL TO REMAIN
- REMOVE SOIL TO DEPTH AS NEEDED FOR PAVEMENT INSTALLATION
- UNDISTURBED AREA, VEGETATION TO REMAIN AS IS. DEAD VEGETATION TO BE REMOVED.

SITE PREPARATION AND DEMOLITION NOTES:

- PRIOR TO COMMENCING ANY EXCAVATION WORK, THE CONTRACTOR SHALL NOTIFY ALL UTILITY COMPANIES IN ACCORDANCE WITH THE "DIG SAFELY" NOTIFICATION PROCEDURES PROMOTED BY RESPECTIVE UTILITY COMPANIES. THE DIG SAFE TELEPHONE NUMBER FOR MASSACHUSETTS IS 811.
- THE LOCATIONS OF ALL UNDERGROUND UTILITIES SHOWN ON THIS PLAN ARE DIAGRAMMATIC ONLY. THE CONTRACTOR SHALL CONTACT THE PROPER LOCAL AUTHORITIES OR RESPECTIVE UTILITY COMPANY TO CONFIRM THE LOCATION OF ALL EXISTING UTILITIES BEFORE COMMENCING WORK. ANY DAMAGE DUE TO FAILURE OF THE CONTRACTOR TO CONTACT THE PROPER AUTHORITIES SHALL BE BORNE BY THE CONTRACTOR.
- ALL REFUSE, DEBRIS AND MISCELLANEOUS ITEMS TO BE REMOVED, THAT ARE NOT TO BE STOCKPILED FOR LATER USE ON THE PROJECT OR DELIVERED TO THE OWNER, SHALL BE LEGALLY DISPOSED OF OFF-SITE BY THE CONTRACTOR.
- ALL ITEMS REQUIRING REMOVAL SHALL BE REMOVED TO FULL DEPTH TO INCLUDE BASE MATERIAL AND FOOTINGS OR FOUNDATIONS AS APPLICABLE, AND REUSED AS DIRECTED BY THE OWNER OR LEGALLY DISPOSED OF OFF-SITE BY CONTRACTOR.
- CONTRACTOR SHALL STRIP AND STOCKPILE EXISTING TOPSOIL TO FULL DEPTH WITHIN LIMIT OF GRADING BEFORE COMMENCING EXCAVATION AND GRADING OPERATIONS. TOPSOIL SHALL NOT BE REMOVED FROM THE SITE, UNLESS APPROVED BY THE LANDSCAPE ARCHITECT.
- AT ALL LOCATIONS WHERE CONCRETE PAVEMENT OR BITUMINOUS CONCRETE ROADWAY ABOUT NEW CONSTRUCTION, THE EDGE OF THE EXISTING CURB OR PAVEMENT SHALL BE SAWCUT TO A CLEAN, SMOOTH EDGE.
- THE CONTRACTOR SHALL BE RESPONSIBLE FOR THE PROTECTION OF ALL EXISTING TREES AND PLANTS DESIGNATED TO REMAIN FOR THE LENGTH OF THE CONSTRUCTION PERIOD. THE PLACEMENT OF PROTECTION DEVICES ADDITIONAL TO THOSE NOTED SHALL, HOWEVER, BE AT THE CONTRACTOR'S DISCRETION.
- DAMAGE NO PLANTS TO REMAIN BY BURNING, BY PUMPING OF WATER, BY CUTTING OF LIVE ROOTS OR BRANCHES, OR BY ANY OTHER MEANS. NO PLANTS TO BE SAVED SHALL BE USED FOR CRANE STAYS, GUYS OR OTHER FASTENINGS. VEHICLES SHALL NOT BE PARKED WITHIN THE DRIP LINE OR WHERE DAMAGE MAY RESULT TO TREES TO BE SAVED. CONSTRUCTION MATERIALS SHALL NOT BE STORED BENEATH TREES TO BE SAVED.
- THE GENERAL CONTRACTOR SHALL VERIFY ALL EXISTING CONDITIONS IN THE FIELD AND REPORT ANY DISCREPANCIES BETWEEN PLANS AND ACTUAL CONDITIONS TO THE LANDSCAPE ARCHITECT PRIOR TO STARTING WORK.
- THE GENERAL CONTRACTOR IS RESPONSIBLE FOR ANY DAMAGE TO EXISTING CONDITIONS THAT ARE DUE TO CONTRACTOR OPERATIONS AND WHICH ARE OUTSIDE THE LIMIT OF WORK.
- THE GENERAL CONTRACTOR SHALL MAINTAIN OR ADJUST TO NEW FINISH GRADE AS NECESSARY ALL UTILITY AND SITE STRUCTURES SUCH AS LIGHT POLES, SIGN POLES, MAN HOLES, CATCH BASINS, HAND HOLES, WATER AND GAS GATES, HYDRANTS, ETC., FROM MAINTAINED UTILITY AND SITE SYSTEMS UNLESS OTHERWISE NOTED ON THE UTILITY DRAWINGS OR AS DIRECTED BY THE LANDSCAPE ARCHITECT.
- THE GENERAL CONTRACTOR SHALL COORDINATE ALL ADJUSTMENT OR ABANDONMENT OF UTILITIES WITH THE RESPECTIVE UTILITY COMPANY.
- ALL POINTS OF CONSTRUCTION INGRESS AND EGRESS SHALL BE PROTECTED TO PREVENT TRACKING OF MUD ONTO PUBLIC WAYS. ANY MUD ON PUBLIC WAYS ORIGINATING FROM THE JOB SITE SHALL BE CLEANED BY THE CONTRACTOR.
- CONTRACTOR SHALL SECURE ALL PERMITS THAT MAY BE REQUIRED FROM ALL JURISDICTION AFFECTED BY THIS WORK.
- CONTRACTOR SHALL COORDINATE ALL PLACEMENT OF TREE PROTECTION TO BE APPROVED BEFORE DEMOLITION.
- CONTRACTOR SHALL PROVIDE A CRUSHED STONE CONSTRUCTION ENTRANCE (3" COARSE AGGREGATE, 6" THICK, 15'X75')
- CONSTRUCTION ENTRANCE TO BE REMOVED BEFORE THE END OF CONSTRUCTION.

HUDSON DOG PARK

HUDSON, MASSACHUSETTS

TOWN OF HUDSON

PARK COMMISSION
DIVISION OF RECREATION
78 MAIN STREET
HUDSON, MA 01749

1	TRENCH LAYOUT	6/2/2025
NO.	REVISION	DATE

kzla
Kyle Zick Landscape Architecture, Inc.
4228 Washington Street
Boston, MA 02131
617 451-1018 Tel
www.kyzezick.com



BID DOCUMENTS

Job Number:

Project: HUDSON DOG PARK

Drawn By: JF RB

Checked By: KZ

Date: 6/2/2025

Scale: 1"=20'-0"

Drawing Title:

SITE PREPARATION
PLAN

SP1

LEGEND

- L.O.W. LIMIT OF WORK LINE
- WOOD CHIPS (6 LD1)
- BITUMINOUS CONCRETE PAVEMENT (3 LD1, 4 LD1)
- CONCRETE PAVEMENT (5 LD1)
- GRANITE CURB (10 LD1)
- MOUNTABLE CURB (11 LD1)
- GRAVEL

MATERIAL NOTES:

1. PROVIDE EXPANSION JOINTS AT ALL CURBS, WALLS, STEPS, LIGHT POLE BASES, PULL BOXES, MANHOLES, ETC. AND AS SHOWN ON PLAN.
2. CONTRACTOR SHALL COORDINATE LOCATION OF ALL UTILITIES (LINES, DUCTS, CONDUITS, SLEEVES, FOOTINGS, ETC.) WITH LOCATIONS OF PROPOSED LANDSCAPE ELEMENTS (WALLS, FENCE, FOOTINGS, TREE ROOTBALLS, PROPOSED LIGHTING FOOTINGS, ETC.). CONTRACTOR SHALL REPORT ANY DISCREPANCIES TO LANDSCAPE ARCHITECT PRIOR TO CONTINUING WORK.
3. LIMIT OF WORK LINE IS NOTED ON DRAWINGS. CONTRACTOR IS RESPONSIBLE FOR ALL DAMAGE DUE TO OPERATIONS INSIDE AND OUTSIDE OF THE CONTRACT LIMIT LINE. ANY AREAS OUTSIDE THE LIMIT OF WORK THAT ARE DISTURBED SHALL BE RESTORED TO ITS ORIGINAL CONDITION AT NO ADDITIONAL COST TO THE OWNER.

LAYOUT NOTES:

1. ALL LINE AND GRADE WORK PER DRAWINGS AND SPECIFICATIONS SHALL BE LAID OUT BY A REGISTERED CIVIL ENGINEER OR SURVEYOR ENGAGED BY THE CONTRACTOR.
2. ALL LINES AND DIMENSIONS ARE PARALLEL OR PERPENDICULAR TO THE LINES FROM WHICH THEY ARE MEASURED UNLESS OTHERWISE INDICATED.
3. STORAGE AREAS FOR CONTRACTOR'S EQUIPMENT AND MATERIALS SHALL BE IN AND WITHIN LIMITS OF WORK AS SHOWN ON PLANS AND AS APPROVED BY THE LANDSCAPE ARCHITECT.
4. CONTRACTOR SHALL VERIFY ALL EXISTING CONDITIONS IN THE FIELD AND REPORT ANY DISCREPANCIES IN THE SITE SURVEY TO THE LANDSCAPE ARCHITECT PRIOR TO STARTING WORK.
5. ALL LAYOUTS FOR WALKS AND PATHS SHALL BE ADEQUATELY STAKED BY THE CONTRACTOR AND APPROVED BY THE LANDSCAPE ARCHITECT PRIOR TO CONSTRUCTION.
6. AUTOCAD FILE WILL BE PROVIDED TO THE CONTRACTOR TO LAYOUT SITE IMPROVEMENTS.

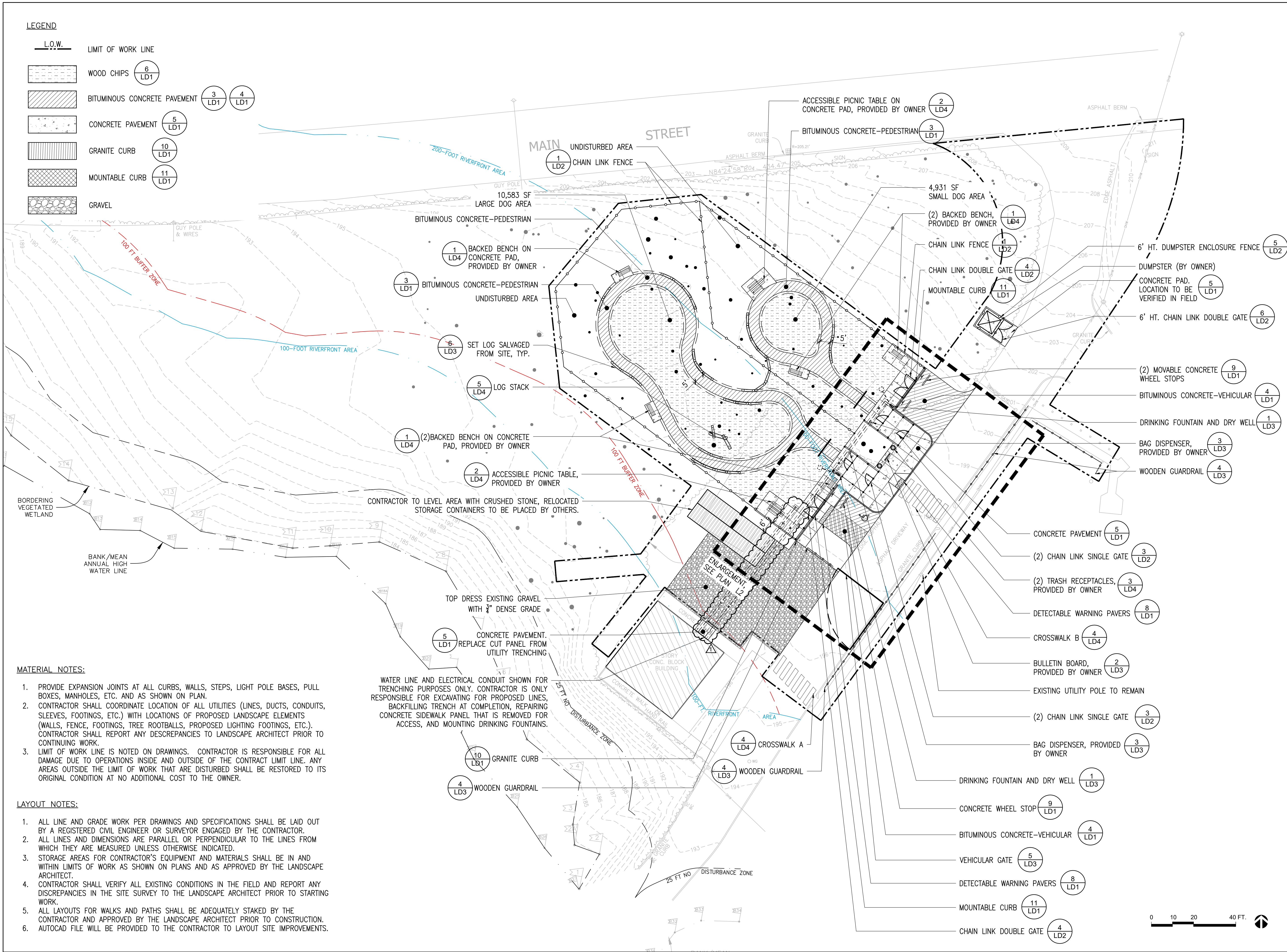

HUDSON DOG PARK

HUDSON, MASSACHUSETTS

TOWN OF HUDSON

PARK COMMISSION
DIVISION OF RECREATION
78 MAIN STREET
HUDSON, MA 01749

1	TRENCH LAYOUT	6/2/2025
NO.	REVISION	DATE

kzla
Kyle Zick Landscape Architecture, Inc.
4228 Washington Street
Boston, MA 02131
617 451-1018 Tel
www.kyzezick.com



BID DOCUMENTS

Job Number:
Project: HUDSON DOG PARK
Drawn By: JF RB
Checked By: KZ
Date: 6/2/2025
Scale: 1"=20'-0"
Drawing Title:

LAYOUT AND MATERIALS PLAN

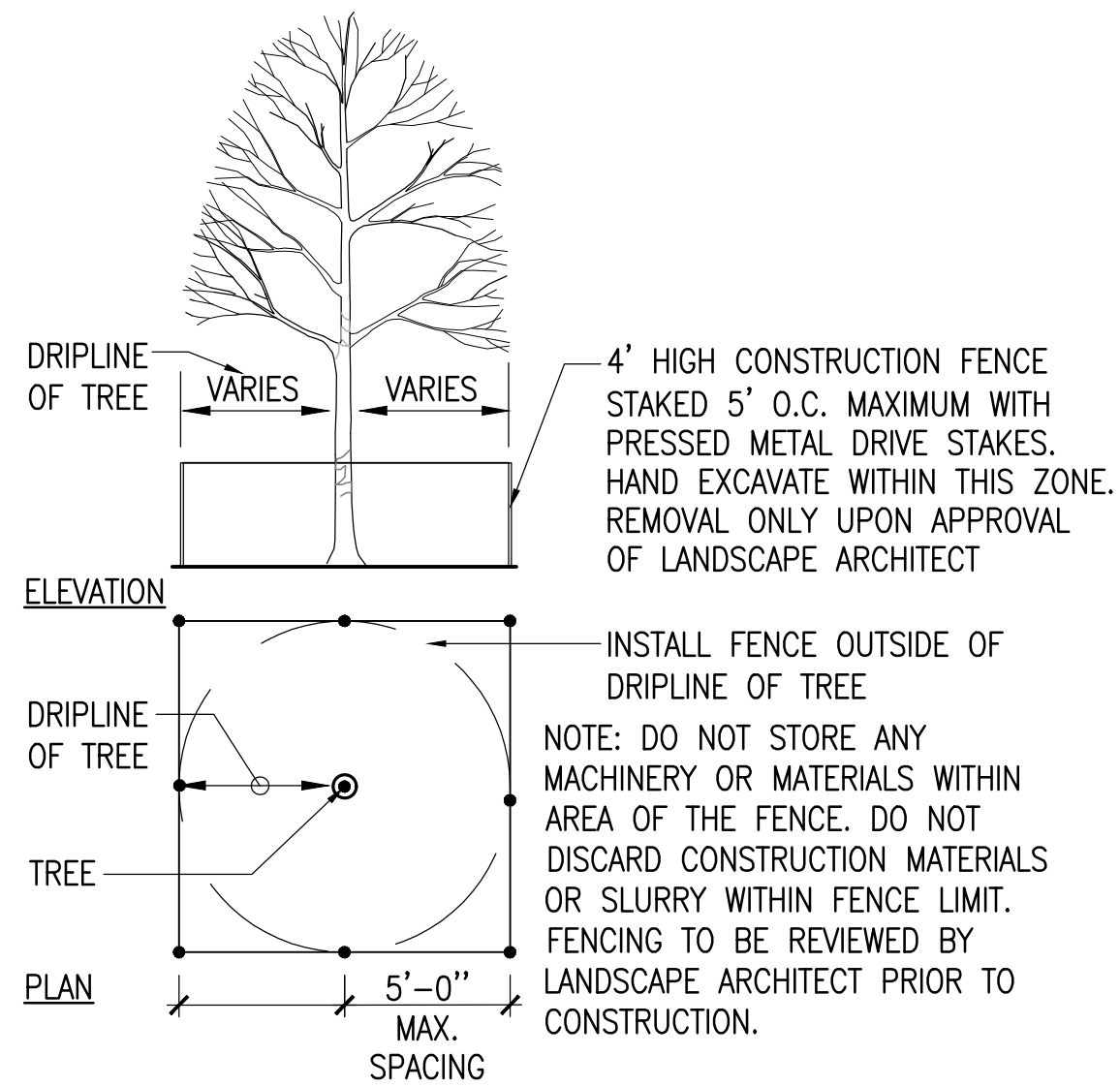

1 TREE PROTECTION FENCE

SCALE: 3/16" = 1'-0"

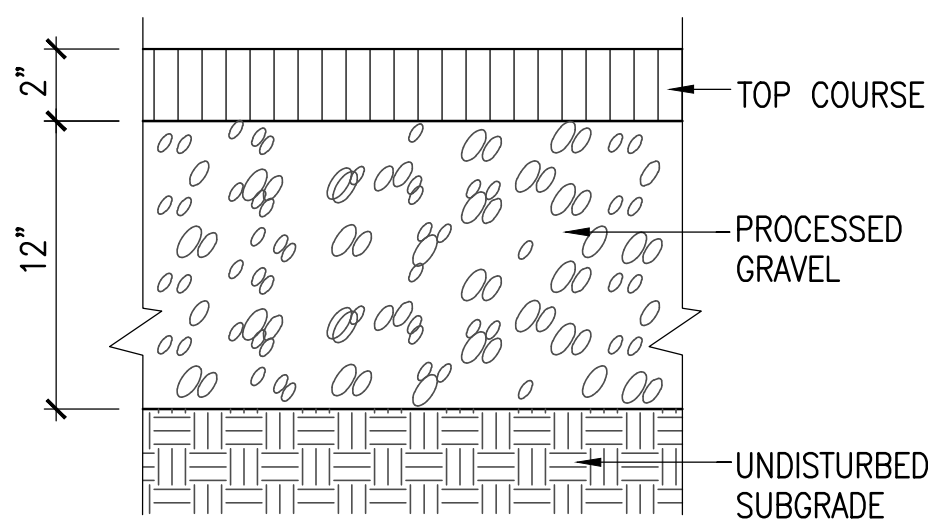

SECTION

3 BITUMINOUS CONCRETE-PEDESTRIAN

SCALE: 1 1/2" = 1'-0"

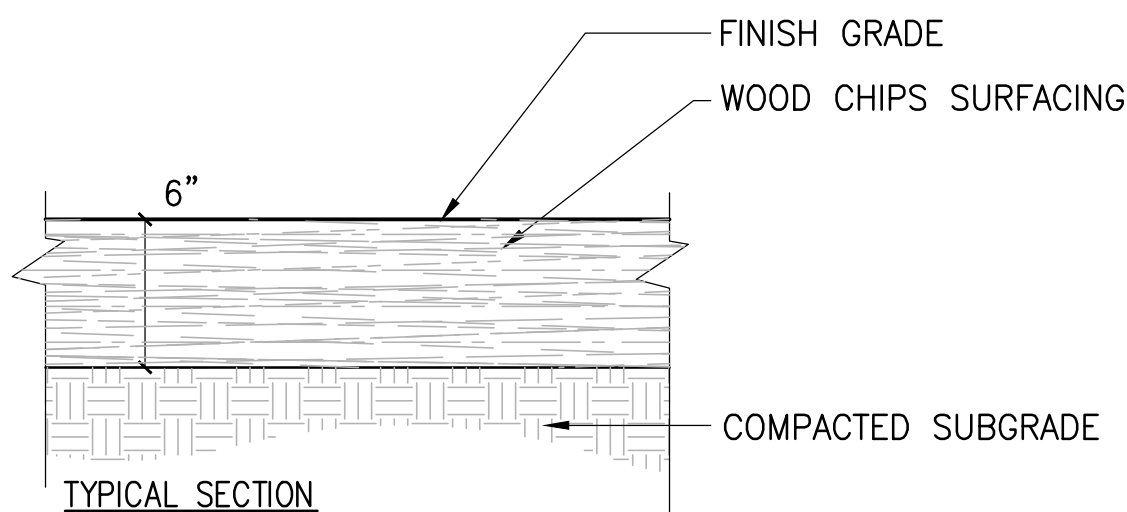

TYPICAL SECTION

6 WOOD CHIP SURFACING

SCALE: 1 1/2" = 1'-0"

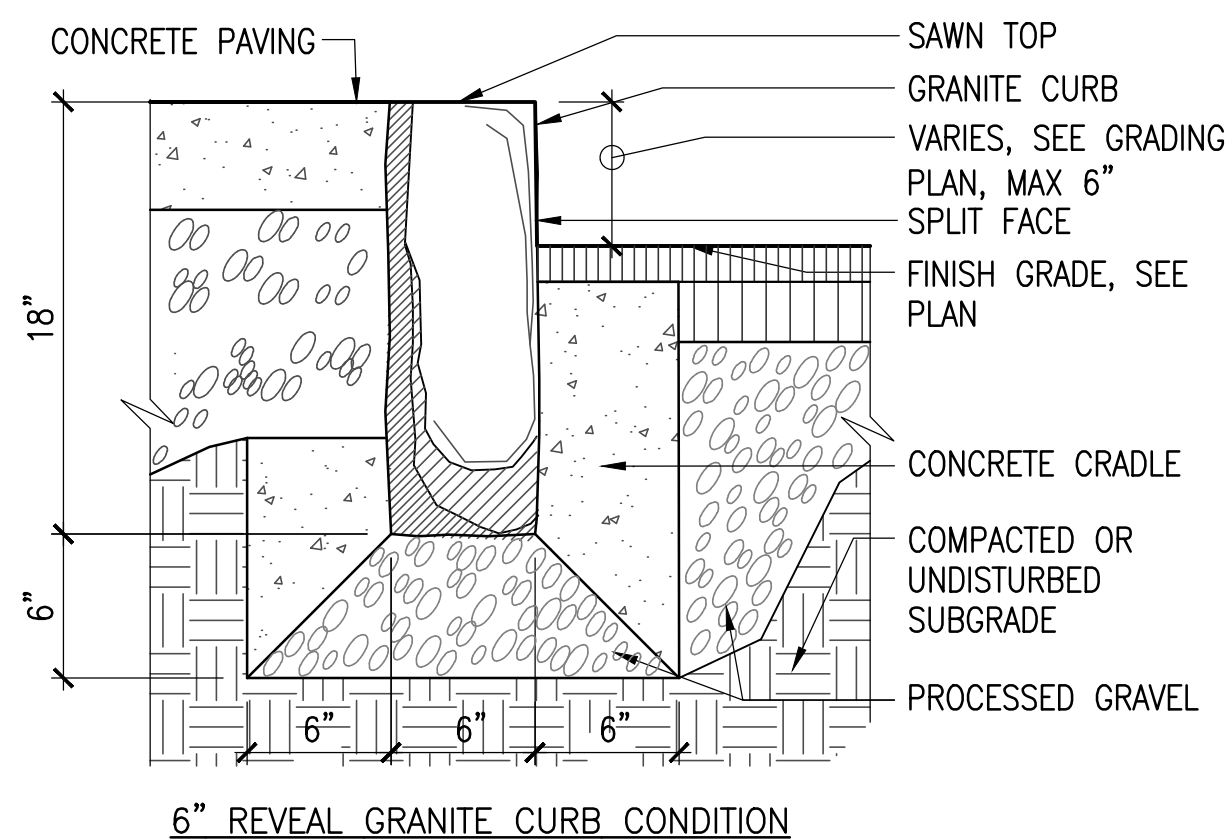

6" REVEAL GRANITE CURB CONDITION

10 GRANITE CURB

SCALE: 1 1/2" = 1'-0"

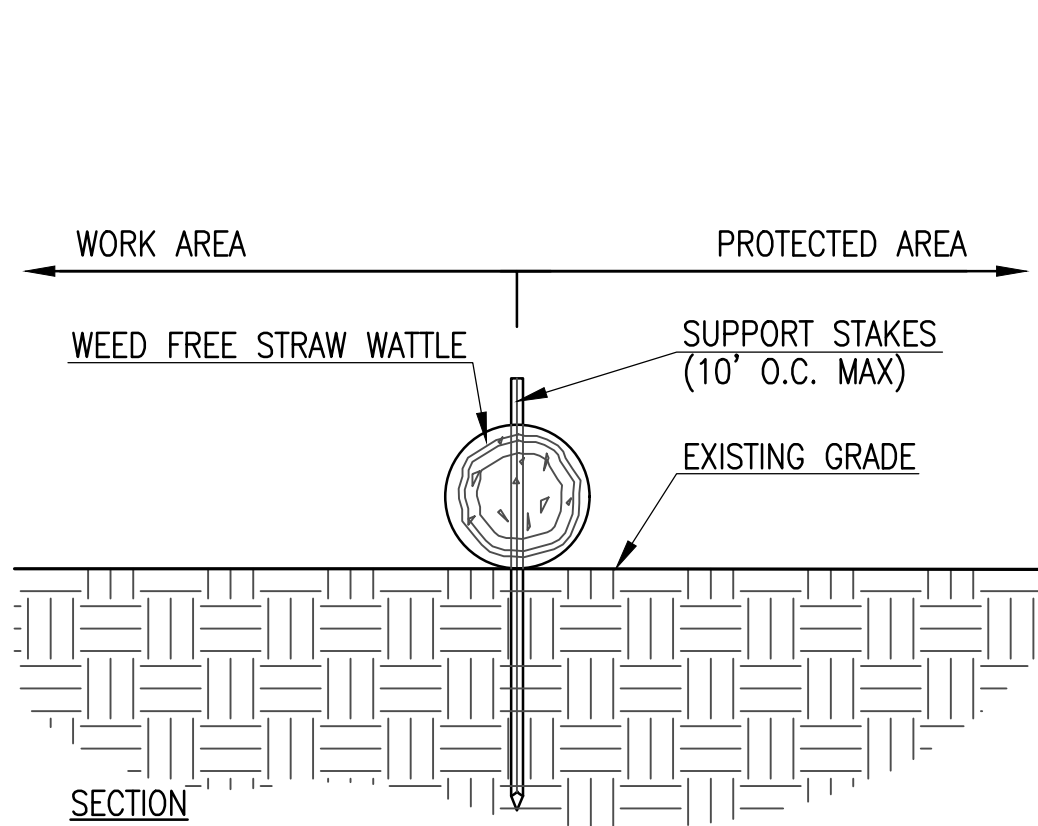

SECTION

2 EROSION CONTROL

SCALE: 3/4" = 1'-0"

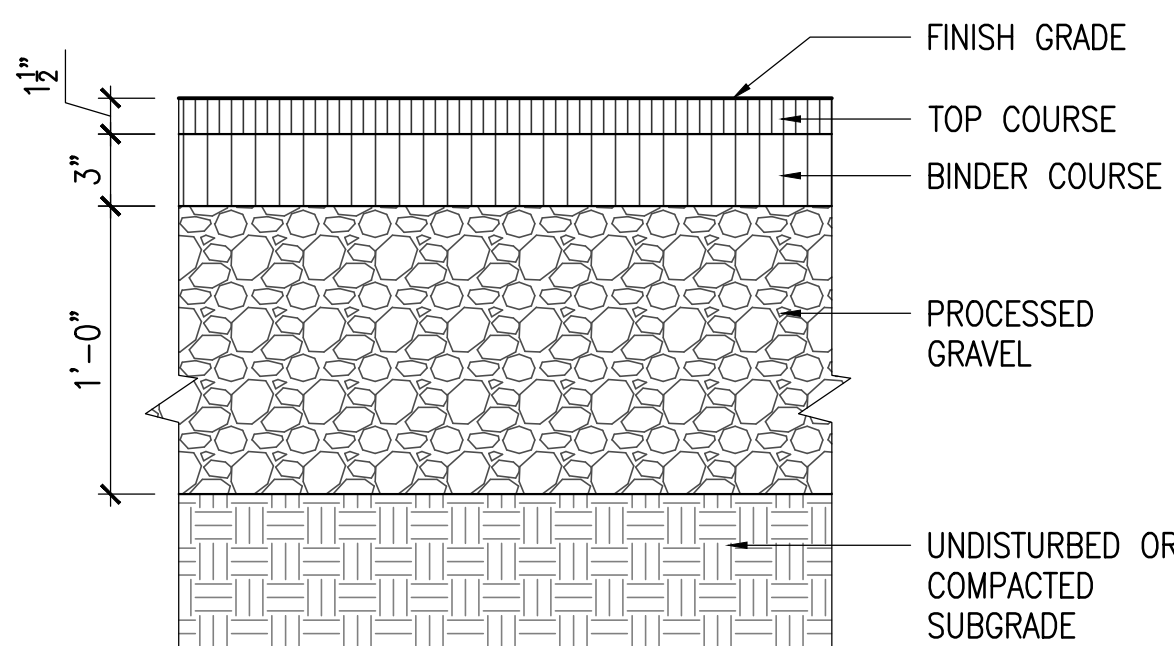

SECTION

4 BITUMINOUS CONCRETE-VEHICULAR

SCALE: 1 1/2" = 1'-0"

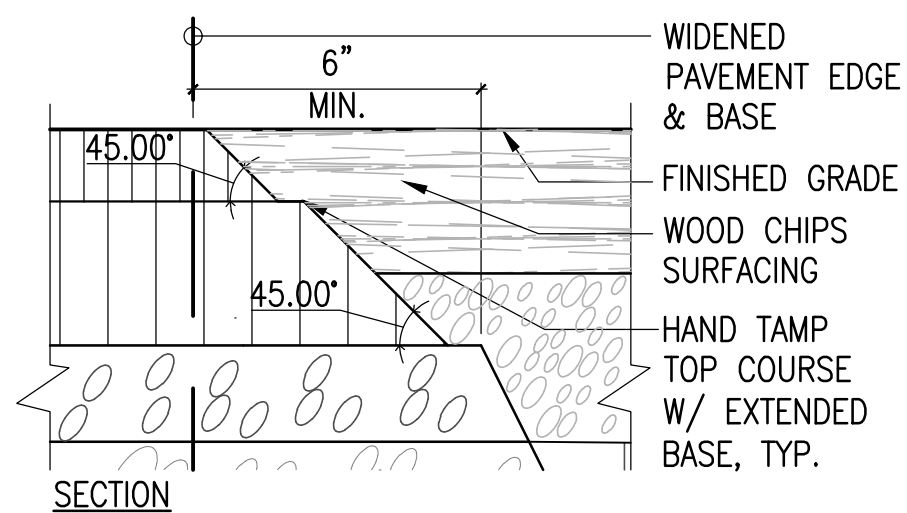

SECTION

7 BITUMINOUS CONCRETE MEETS WOOD CHIPS

SCALE: 3" = 1'-0"

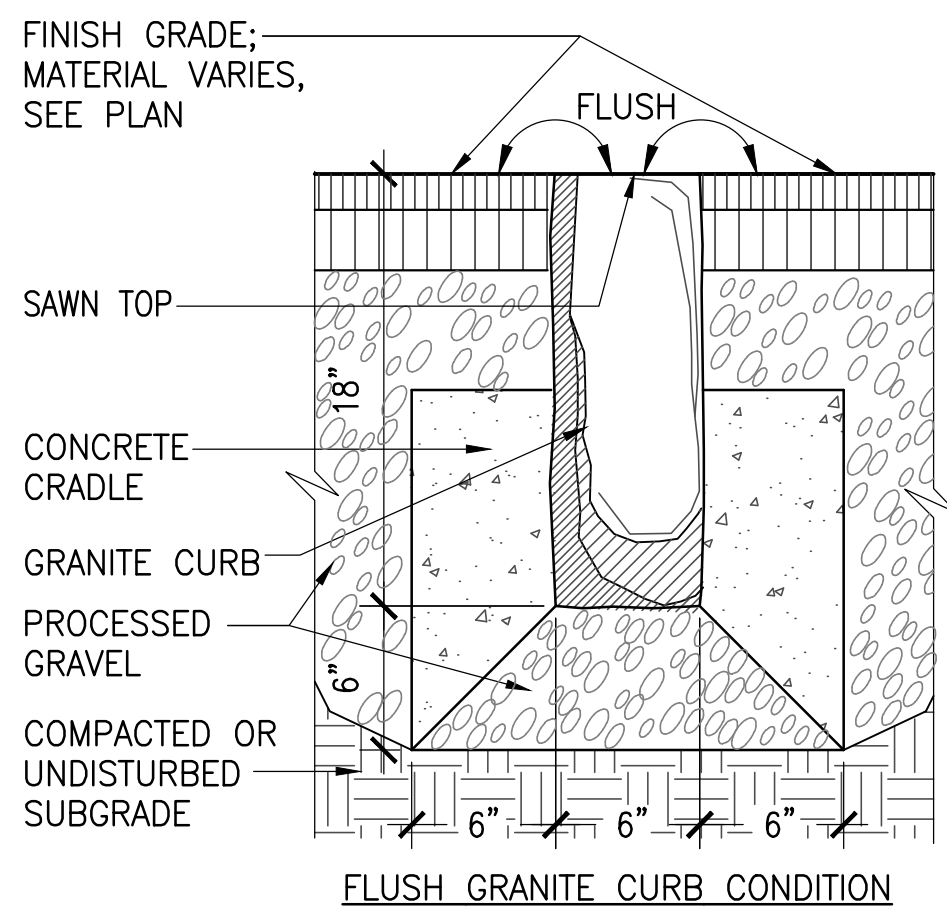

FLUSH GRANITE CURB CONDITION

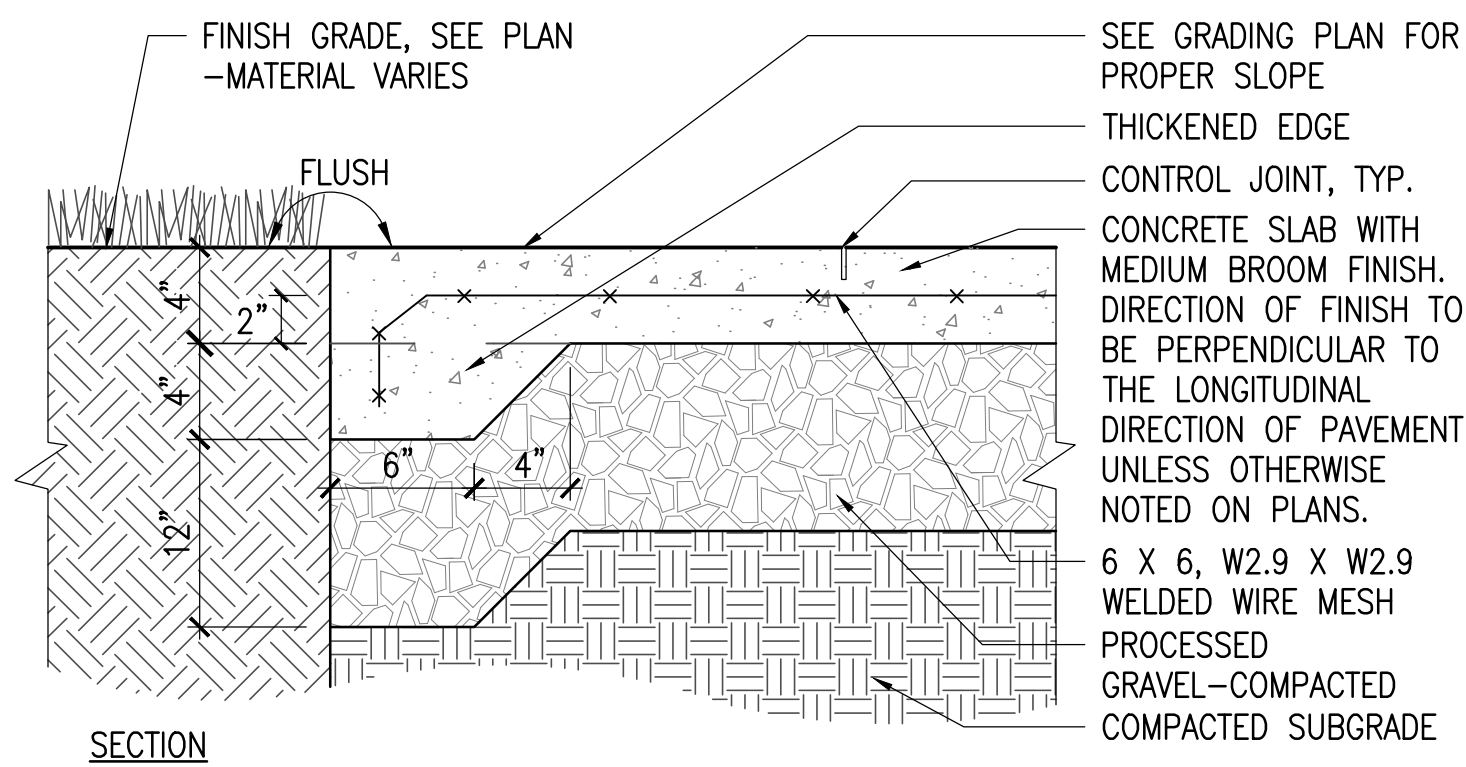

SECTION

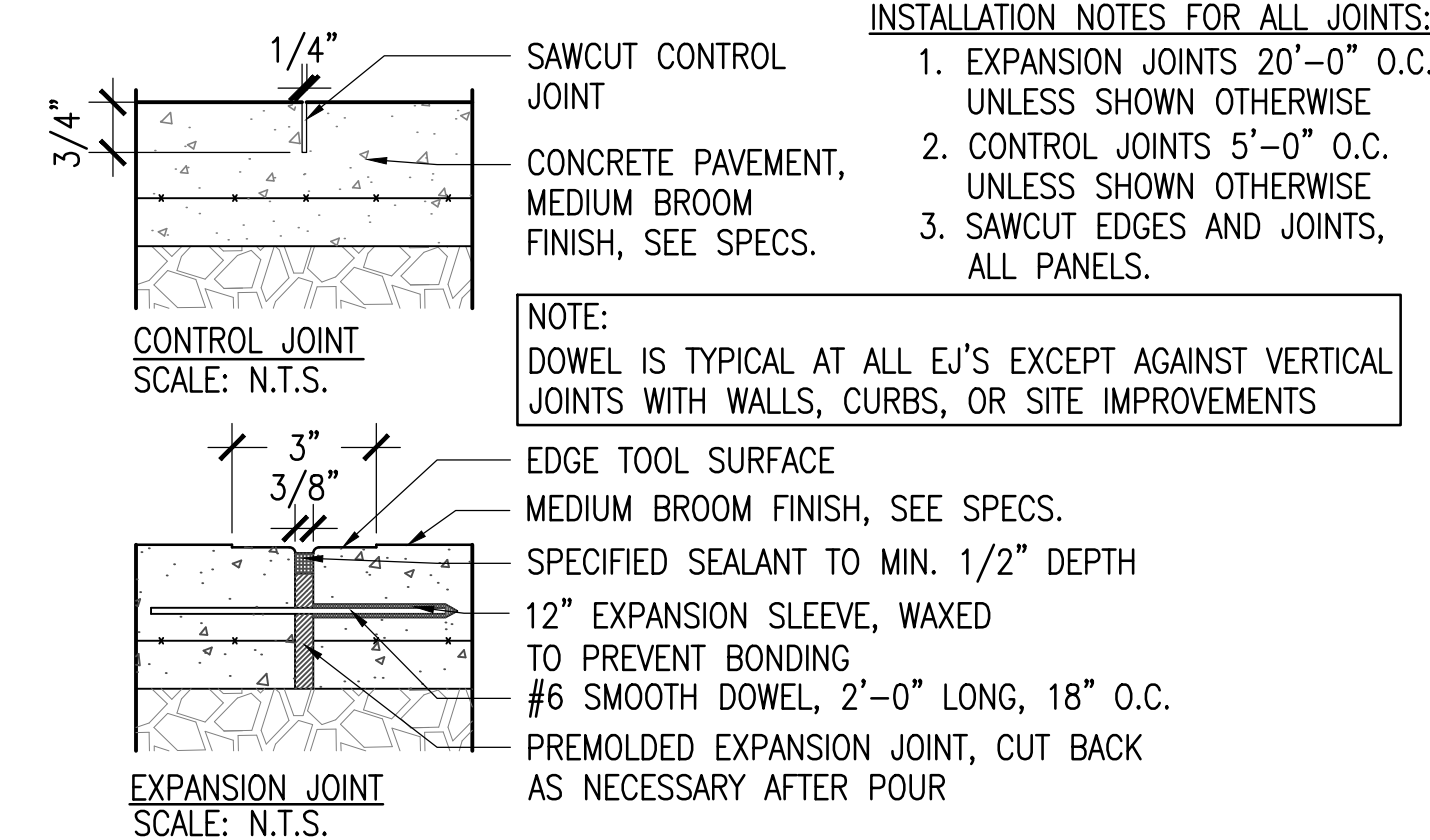

EXPANSION JOINT SCALE: N.T.S.

5 CONCRETE PAVEMENT

SCALE: 1 1/2" = 1'-0"

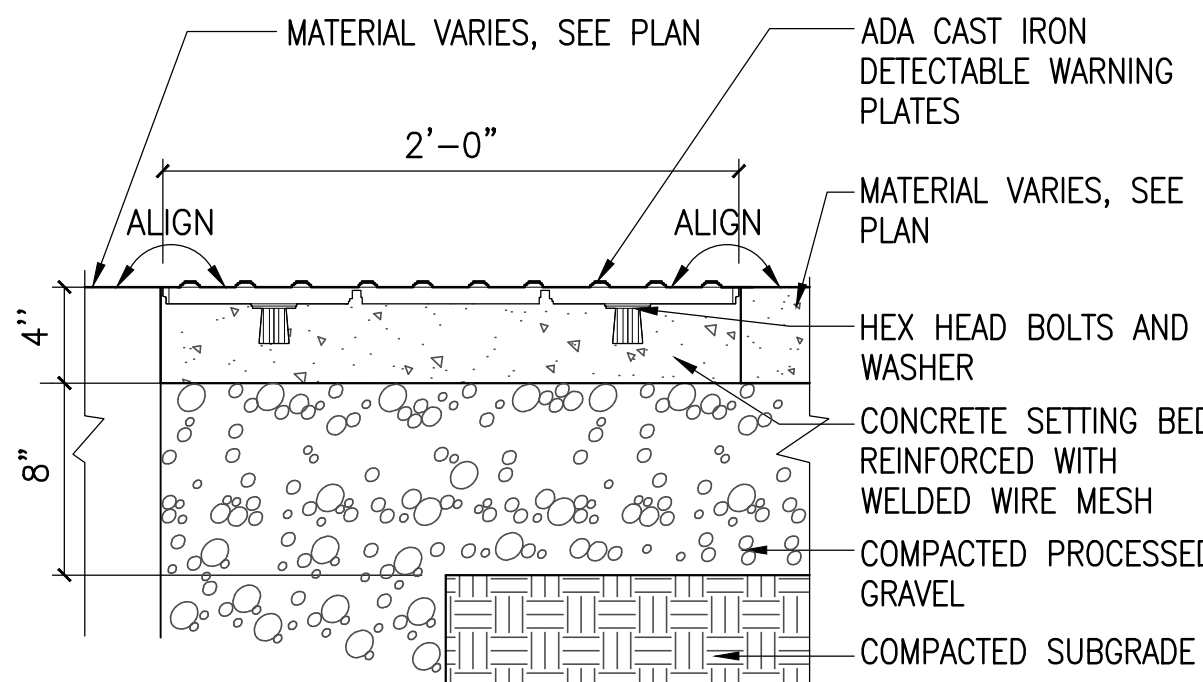

SECTION

8 DETECTABLE WARNING PAVERS

SCALE: 1 1/2" = 1'-0"

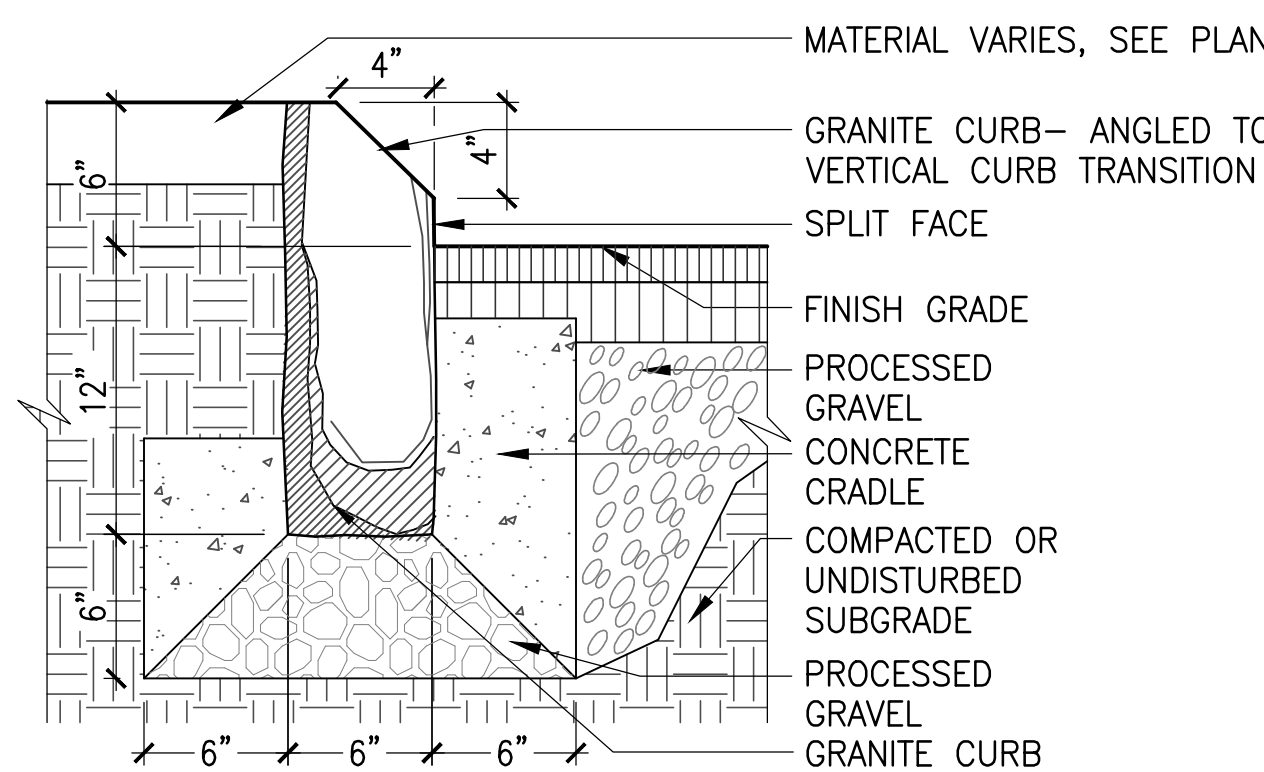

11 MOUNTABLE CURB

SCALE: 1 1/2" = 1'-0"

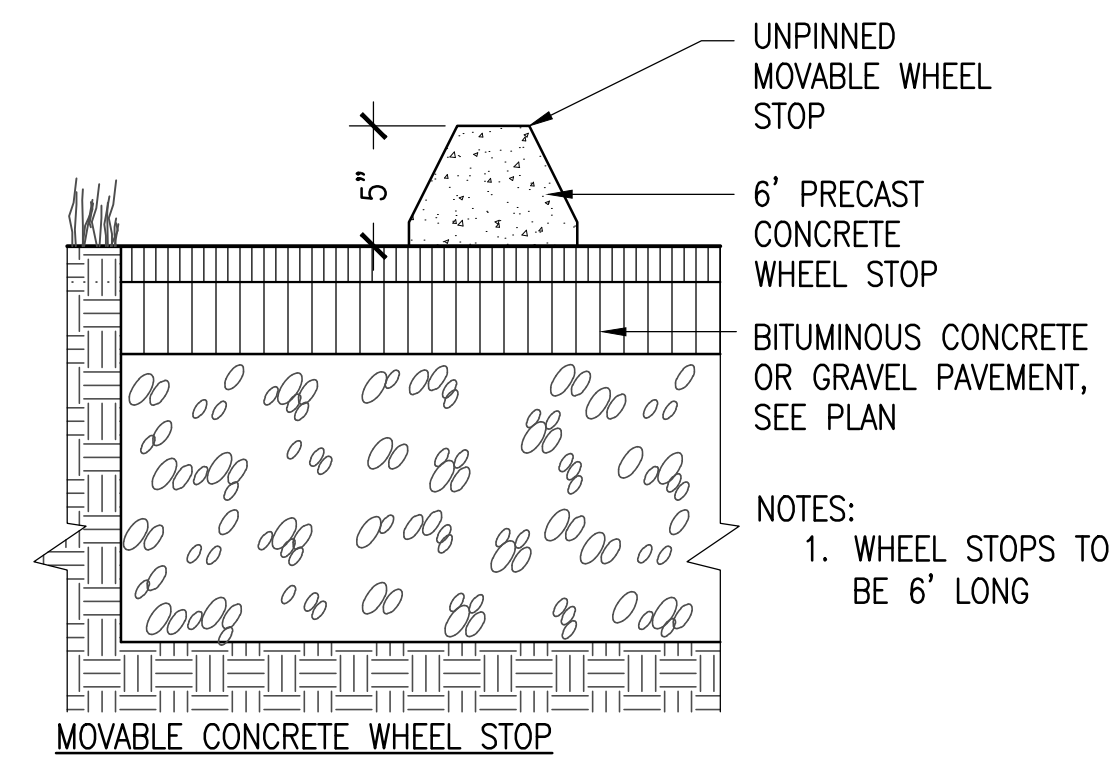

MOVABLE CONCRETE WHEEL STOP

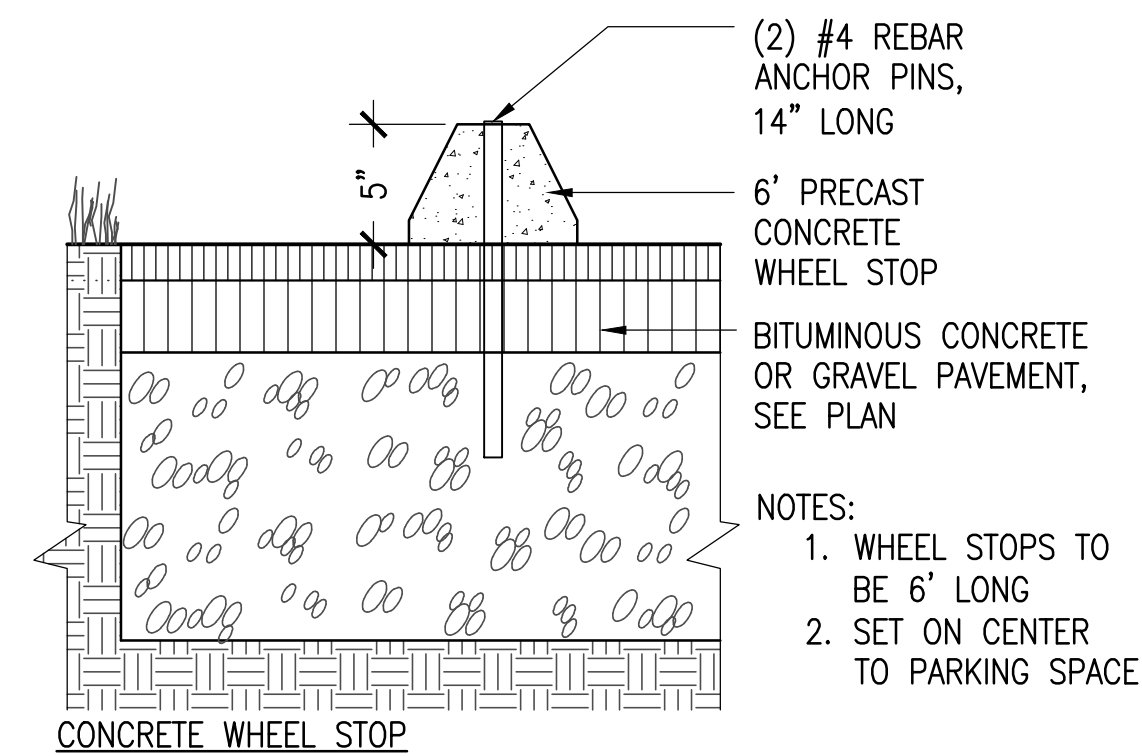

CONCRETE WHEEL STOP

9 CONCRETE WHEEL STOP

SCALE: 1 1/2" = 1'-0"

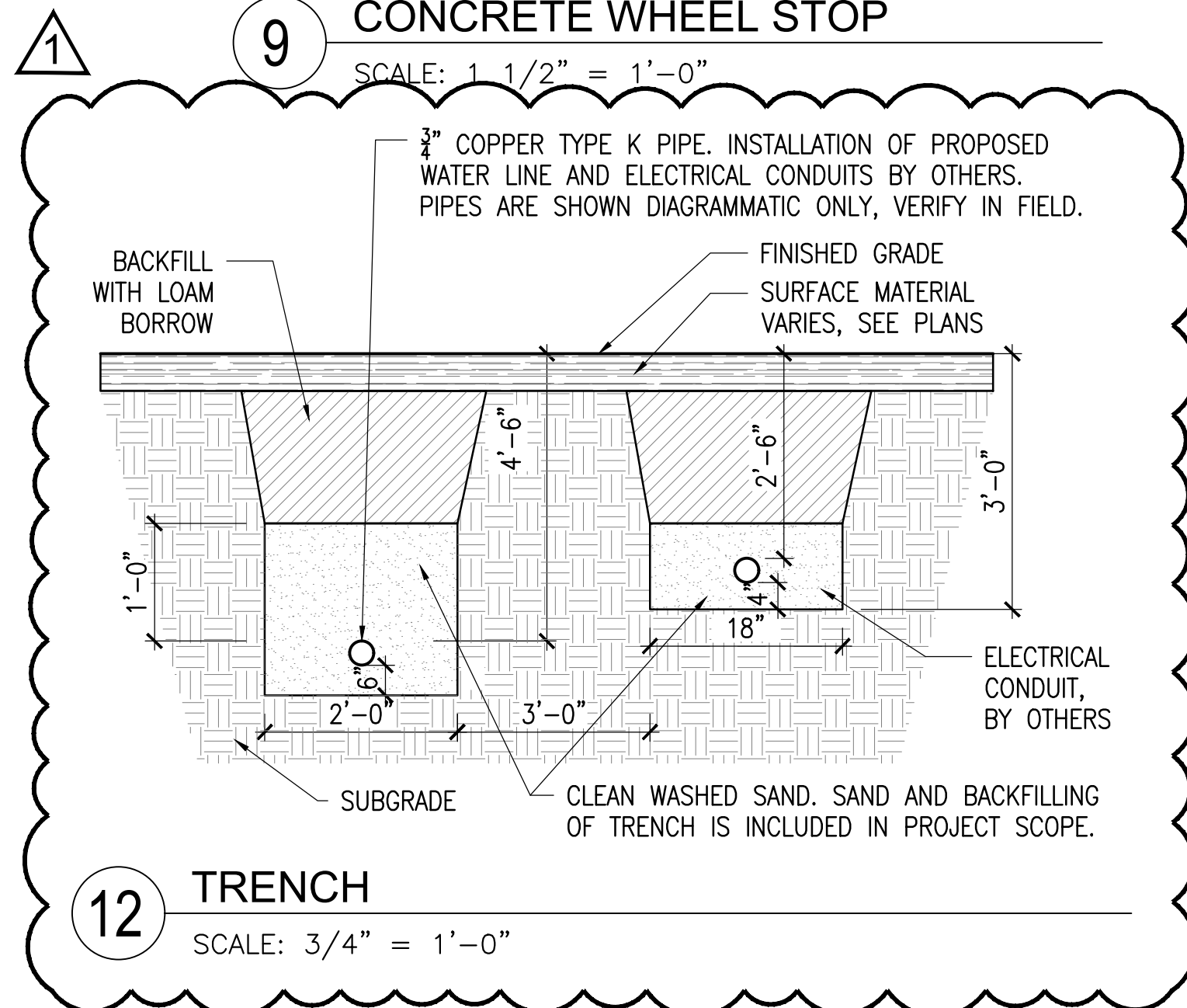

12 TRENCH

SCALE: 3/4" = 1'-0"

HUDSON DOG PARK

HUDSON, MASSACHUSETTS

TOWN OF HUDSON

PARK COMMISSION
DIVISION OF RECREATION
78 MAIN STREET
HUDSON, MA 01749

1	TRENCH LAYOUT	6/2/2025
---	---------------	----------

NO.	REVISION	DATE
-----	----------	------

kzla
Kyle Zick Landscape Architecture, Inc.
4228 Washington Street
Boston, MA 02131
617 451-1018 Tel
www.kyzezick.com



BID DOCUMENTS

Job Number:

Project: HUDSON DOG PARK

Drawn By: JF RB

Checked By: KZ

Date: 6/2/2025

Scale: AS NOTED

Drawing Title:

DETAILS

LD1